

# Dolphin Park

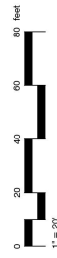

1 Sensory elements on inside of wall



2 Examples of sensory ground textures



3 Freerides interactive play/instruments



4 Examples of sensory wall textures

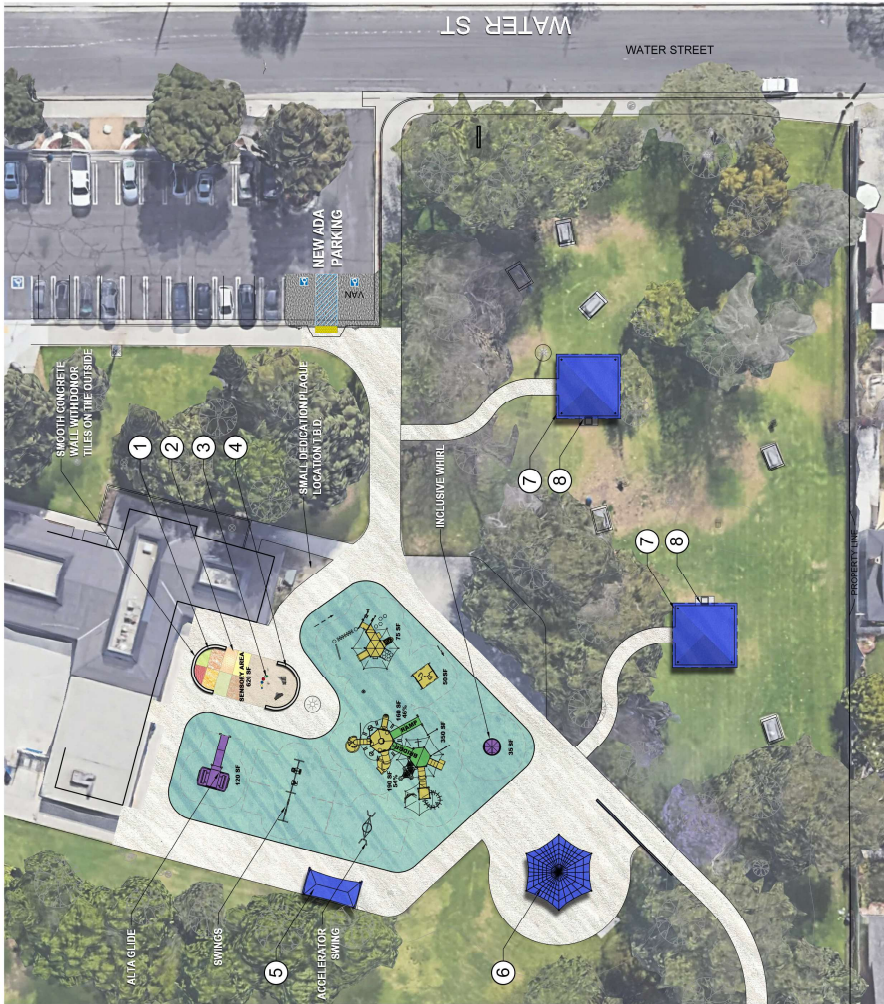

PLAY STRUCTURES			
LEGEND	PLAY STRUCTURES	PLAY STRUCTURES	PLAY STRUCTURES
COLORED SAFETY SURFACING	RAMP ACCESSIBLE AREA	160 SF	34%
PLANTING AREAS	NON-RAMP ACCESSIBLE AREA	315 SF	66%
DECORATIVE CONCRETE	ADDITIONAL WHEEL CHAIR ACCESSIBLE EQUIPMENT	155 SF	
NEW CONCRETE	ADDITIONAL WHEEL CHAIR ACCESSIBLE SENSORY AREA	620 SF	



5 10x20' cantilevered shade structure with benches



6 28' hex fabric shade shelter with picnic tables



7 24' shade structure with picnic tables

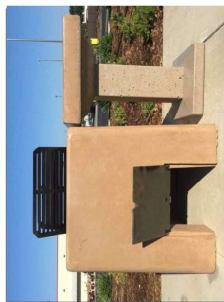

8 BBQ/hot coal receptacle unit

ACCESSIBLE RAMP NOTE:  
RAMPS AND PLAY SURFACE WILL BE  
ADJUSTED TO MEET ADA REQUIREMENTS



# Dolphin Park

Carson, California

## Play Equipment Option - 1

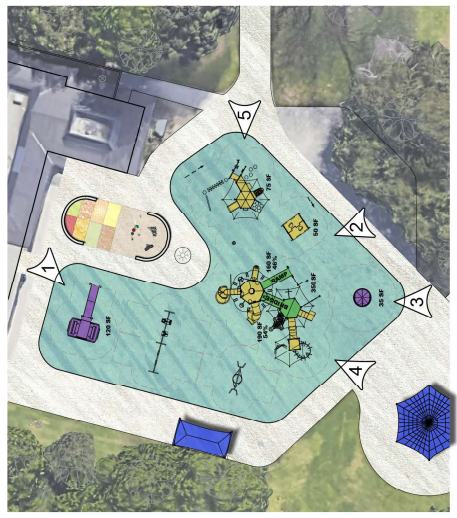

SITE MAP

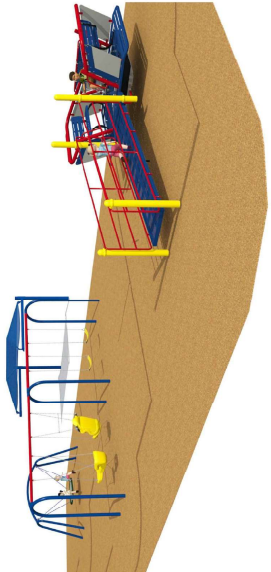

① Looking Southwest



② Looking Northwest

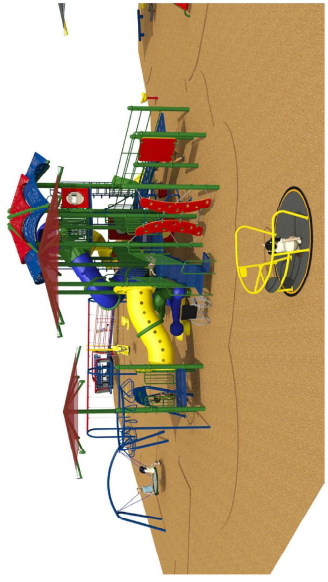

③ Looking North

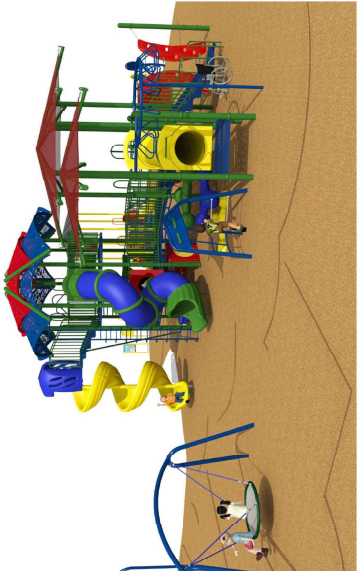

④ Looking Northeast

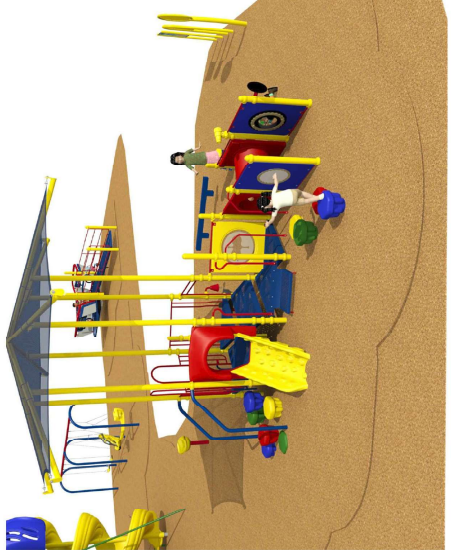

⑤ Looking West



1 Sensory elements on inside of wall



2 Examples of sensory ground textures



3 Freestanding interactive play instruments



4 Examples of sensory wall textures

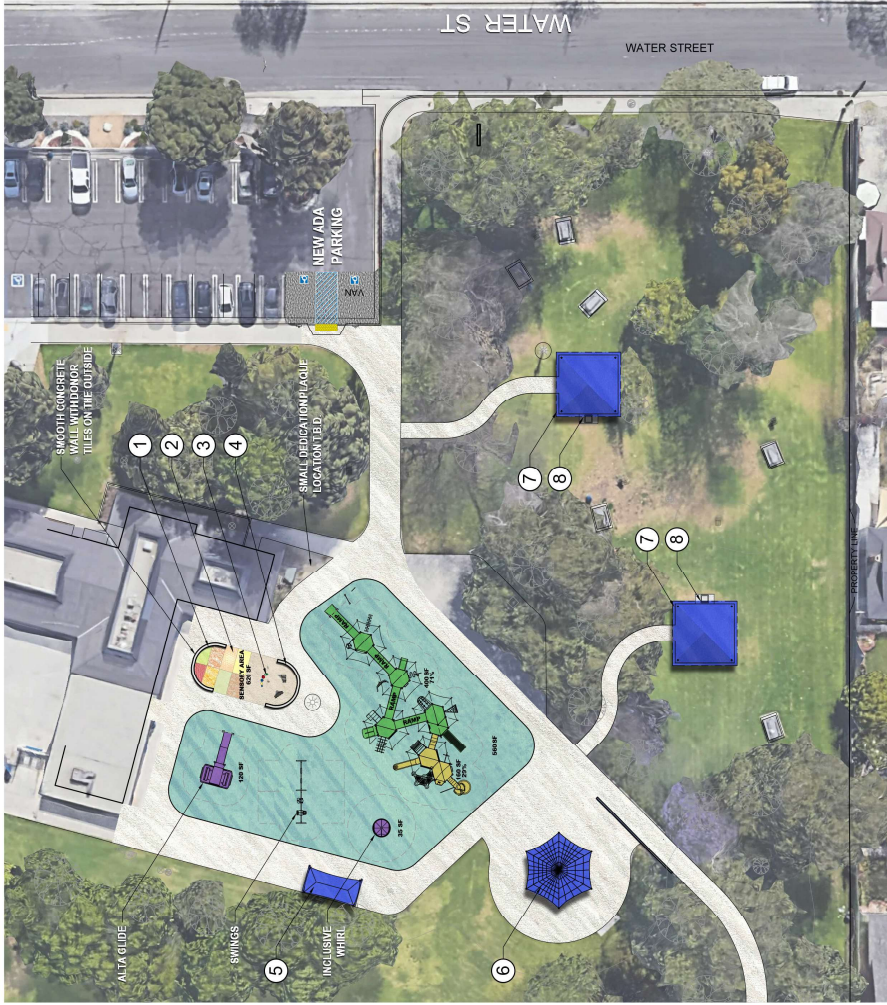
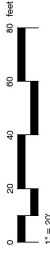

PLAY STRUCTURE

400 SF	71%
160 SF	29%
155 SF	
620 SF	

LEGEND

COLORED SAFETY SURFACING
PLANTING AREAS
DECORATIVE CONCRETE
NEW CONCRETE

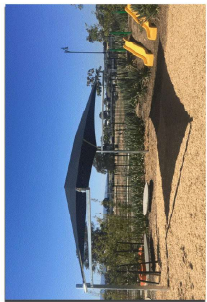

5 10x20' cantilevered shade structure with benches



6 28' hex fabric shade shelter with picnic tables



7 24' shade structure with picnic tables

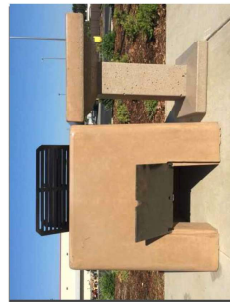

8 BBQ/hot coal receptacle unit

ACCESSIBLE RAMP NOTE:  
RAMPS AND PLAY SURFACE WILL BE  
ADJUSTED TO MEET ADA REQUIREMENTS



# Dolphin Park

Carson, California

## Play Equipment Option - 3

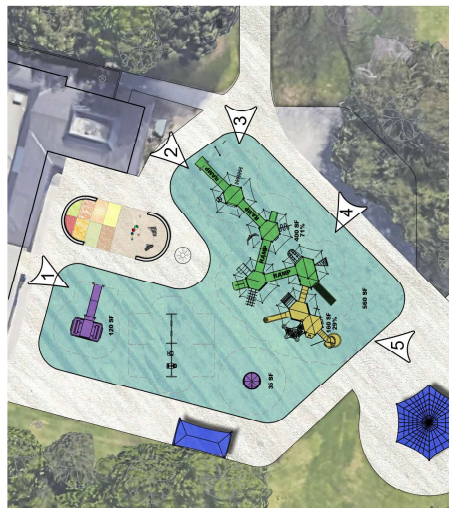

SITE MAP



① Looking Southwest



② Looking Southwest

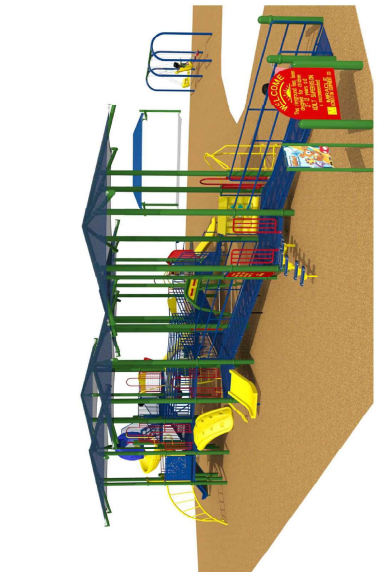

③ Looking West

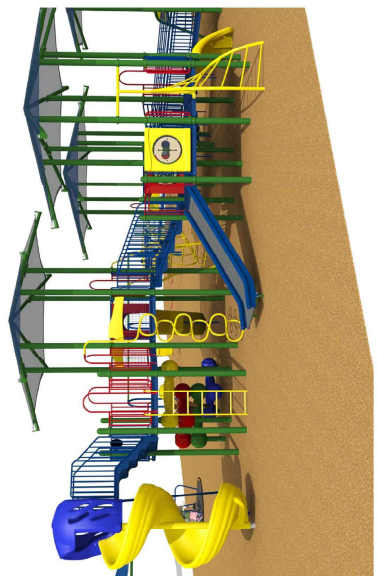

④ Looking Northwest

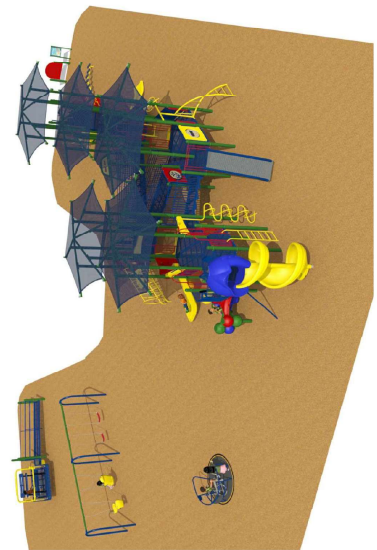

⑤ Looking North